

**General notes: Series CW 18-16-14 and 12**

Doors are fabricated from 18,16,14 or 12gage, zinc coated carbon steel conforming to ASTM A-653 with ZF75 (A25) designation, ZF180 (A60) designation or a Z275 (G90) designation. Doors shall have standard manufacturer's (beveled 1/8" in 2") CW seamless edge construction with inverted channels stiles 18 gage fully welded center seam, no putty, with inverted channels top and bottom of door. All doors shall be prepared for fully templated hardware, including thru bolt holes. Reinforcing only will be supplied for all surface-mounted hardware, drilling and tapping for surface hardware will be done in field. Provide manufacturer's standard steel glass kits and louvers.

**CORES**

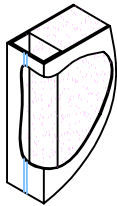

**Urethane (URE)**  
Solid block urethane core with "U" factor of .08 and a "R" value of 12.15 or better

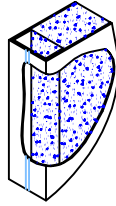

**Polystyrene (STY)**  
Solid block polystyrene core with "U" factor of .16 and "R" value of 6.38 or better

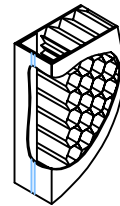

**Honeycomb (HC)**  
Kraft impregnated core with 1" diameter cell., bonded securely to both skins

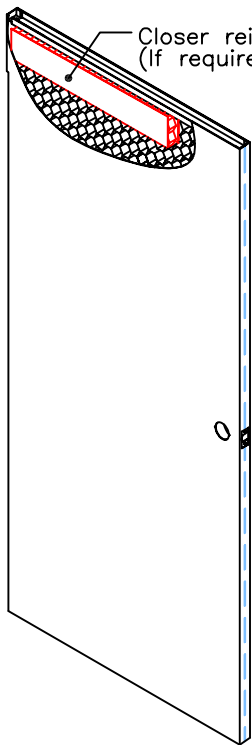

**CW DETAIL**

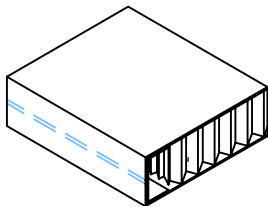

CW Seamless, internally channeled stiles, 16 or 14 gage. Fully welded centered seam, no putty

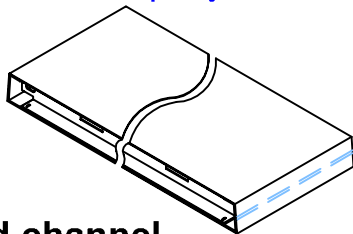

**Standard End channel**

NOTE: A60 Zinc coated carbon steel is not available in 12 gage

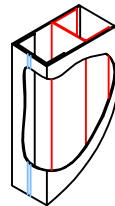

**Steel stiffened (STL)**  
with vertical 18gage steel stiffeners, 6" on center, with Polystyrene or Urethane.

**HINGE AND STRIKE**

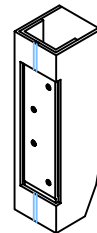

Standard 10gage hinge reinforcement

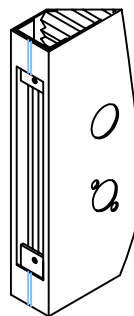

Ansi A156.13 "86" edge with function holes, 12gage lock front and 16gage box

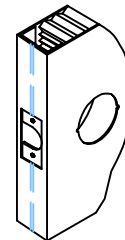

Ansi A156.2 "161", 12gage lock front and 18gage spacer